

SHELF ACCESSORIES

WIRE CANDY RACK^D

The Wire Candy Rack for Gondola/Wall shelving is used to display small boxes of candy, cookies and other snack items. It may be used on either a Base Shelf or an Upper Shelf. The unit is 24" tall and 8" deep. It is available in 36" or 48" widths with 1" OC wire spacing.

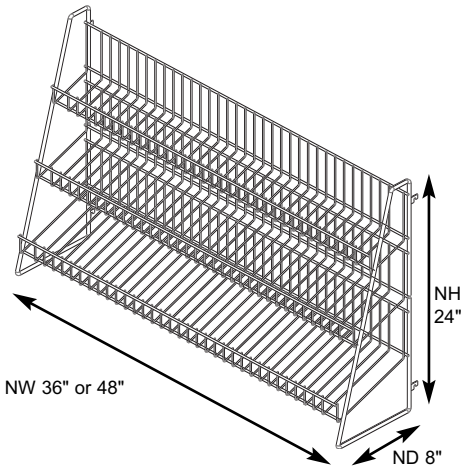

Width			Wt.
36"	WCANR-36	\$79.45	10.4
48"	WCANR-48	\$79.45	13.0

• *Optional color... add \$3.00 each.*

WCANR-(NW)

WCANRWire Candy Rack
 NWNominal Width 36", 48"
(91.44 cm, 121.92 cm)

WIRE CANDY RACK FOR GONDOLA^D

The Wire Candy Rack for Gondola/Wall shelving is used to display small boxes of packaged candy, cookies and snacks. Designed to be used on the Base Shelf of Gondola/Wall shelving. The unit is 48" tall and 13½" deep. It is available in 36" or 48" widths with 1" OC wire spacing.

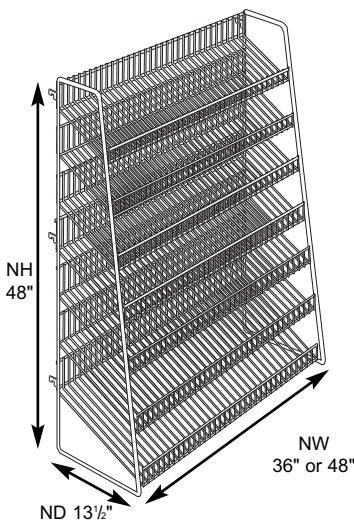

Pocket Depth Detail

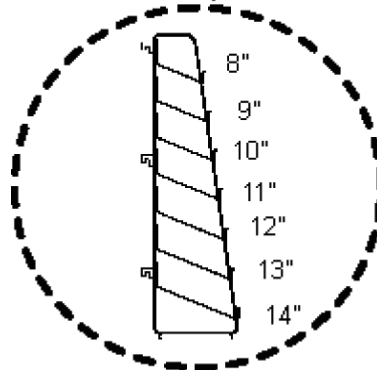

WCRFG-(NW)

WCRFGWire Candy Rack for Gondola
 NWNominal Width 36" or 48" (91.44 cm or 121.92 cm)

Width			Wt.
36"	WCRFG-36	\$160.20	27.9
48"	WCRFG-48	\$160.20	35.7

• *Optional color... add \$5.00 each.*

TEN LEVEL WIRE CANDY RACK FOR GONDOLA^C

The Ten Level Wire Candy Rack for Gondola ships as one piece providing quick installation into any Madix Gondola/Wall Uprights. Each individual pocket has a 13 degree slant from the back to the front of the unit. This slant naturally feeds merchandise in front of the customers. Every wire candy pocket has a 1¼" metal tag mold and 1" OC wire spacing. The top pocket is 6" deep, the second pocket is 10" deep, while the remaining pockets are 12" deep. Load capacity is 250 lbs.

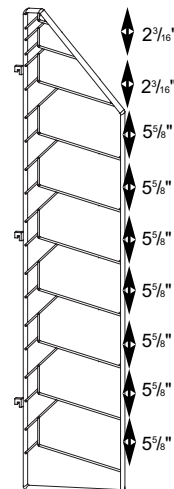
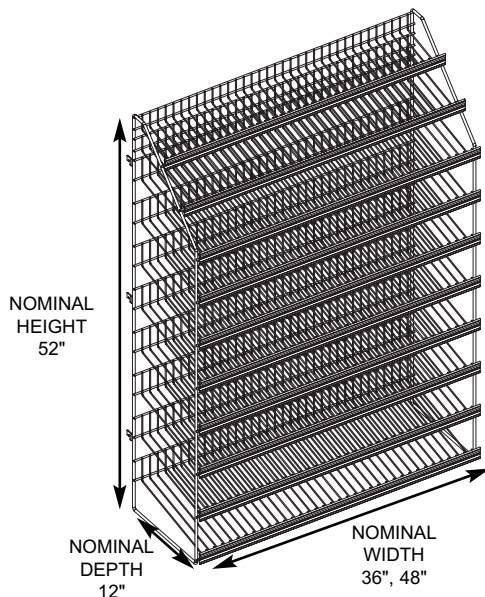

WCRG10L-(NW)(ND)

WCRG10L ..Ten Level Wire Candy Rack for Gondola
 NWNominal Width 36", 48" (91.44 cm, 121.92 cm)
 NDNominal Depth 12" (30.48 cm)

DEPTH	WIDTH			
	36"	WT.	48"	WT.
12"	\$241.30	39.4	\$241.30	49.8

Optional Color... add \$10.00

2.88

Copyright © 2005 Madix, Inc.

Prices and specifications subject to change without notice.

